



Riverstone Homeowners Association Inc.  
(Moon Valley Subdivision)

## Entrance Gate Instructions

### Guest Communication

Your name and telephone number will be programmed into the telephone entry system under a specific DIRECTORY CODE. This directory code is a three-digit number assigned specifically to you. Your DIRECTORY CODE will be shown to the right of your name. Your guest will enter this code on the system keypad, and this will cause the system to place a call to your home. (If your guest already knows your directory code, they can simply enter the code without having to look up your name.) When your name is displayed in the directory, the guest can also press the CALL button to establish communication with your home.

### Granting or Denying Access

Once you have answered the phone call and have identified your guest, you have the choice to either grant or deny access.

- To grant access to your guest, simply press “9” on your touch tone phone. The entry system will respond with a confirmation tone indicating that the gate is opening and will automatically disconnect itself.
- To deny access simply press the #key or hang up the phone.

### Call Waiting

If you are on the telephone when a guest tries to contact you from the gate, they will hear a busy signal and will have to wait for you to end your call before they can contact you. To eliminate this problem, you can order call waiting from your telephone provider.

### Access Code

A unique 4-digit access code is assigned to each lot owner. DSI will input it into the system. To use the access code, FIRST PRESS THE “#” KEY, then enter the four-digit code. \*\*We strongly encourage you not to give out your Access Code. The proliferation of Riverstone HOA Access Codes could undermine the security provided by the gates being closed.

### Gate Dual-Purpose Vehicle RFID Windshield/Headlamp Tag

The first owner of every property is given up to two (2) gate *Dual-Purpose Vehicle RFID Windshield/Headlamp Tag* (“RFID Tag”), as appropriate, at no charge. Additional RFID Tags for future owners and/or replacement tags are \$20.00 each. For optimum performance, the RFID Tag must be installed on the windshield or headlamp. The HOA is not responsible for installing, lost, stolen or damaged RFID Tag(s) and does not accept returned RFID Tag(s). The homeowner is responsible for the maintenance of the RFID Tag from that point.

**NOTE:** *Once the tag is mounted, do not attempt to remove the tag. This will damage the tag and tag will become inoperable. For your convenience, a Dual-Purpose Vehicle RFID Windshield/Headlamp Tag Installation Guide is attached to these instructions, are available upon request to [Jean@dev-services.com](mailto:Jean@dev-services.com) and posted on the association’s webpage at [www.dev-services.com](http://www.dev-services.com) click the drop down arrow and select your subdivision’s name “Riverstone (Moon Valley)”.*

### Current Gate Hours (rev 2/01/2024)

The HOA Board (Developer Representatives) will shut the entrance gate overnight. **Entrance Gate Closed 6pm to 5am**

## **ONCE GATES ARE CLOSED 24/7, THE BELOW INFORMATION WILL APPLY**

### Gate Open Request - Open Houses/Parties

If you would like to have the gates open for an open house or a party, you can request a specific time you would like to have the gate open by e-mailing Development Services [Jean@dev-services.com](mailto:Jean@dev-services.com) or call 208-939-6000. (Remember that you do not have to have the gate open for the full amount of the scheduled party time but just the first few hours.) Plan ahead; identify yourself as a Riverstone HOA property owner, requests are to be received with minimum of 5 business days’ advance notice.

### Temporary Codes

A temporary code can be assigned to you by e-mailing Development Services [Jean@dev-services.com](mailto:Jean@dev-services.com) at least 5 business days ahead. Let them know what code you would like and when it is to expire. Make sure to identify yourself as a Riverstone HOA property owner. Only requests from owners will be honored. Uses for a temporary code can be parties, out-of-town guests, a realtor, and/or an open house. It is preferable if service providers utilize the directory system to request access from the homeowner.

## Dual-Purpose Vehicle RFID Windshield/Headlamp Tag Installation Guide

### Choosing a Proper Tag Mounting Location:



For optimum performance, LiftMaster Dual-Purpose RFID Tag (Windshield/Headlamp) must be installed on a windshield location or other suitable mounting point that is facing the RFID reader during normal driving.

### Cure Time:

Once the tag has been installed on the vehicle, there will be a period of time necessary to allow the tag's adhesive to cure. Due to temperature and humidity variations the total cure time may vary. Most applications will experience an 80% cure of the adhesive within 1 hour and full adhesive cure within 24 hours of application. **Please do not wash the area where the tag is installed or disturb the tag for 24 hours after installation.**

### RFID Tag Removal:

1. Gently peel the top layer of the RFID tag from the vehicle surface, the adhesive and antenna layer should remain on the vehicle and is a function of the tag's security.
2. Generously spray a mild glass cleaner on the adhesive layer and let it soak in for around 10-20 seconds.
3. Using a micro-fiber towel or cloth, rub the adhesive with the towel in a circular motion. The adhesive should pull up in a similar manner to rubber cement.
4. Repeat steps 2 and 3 until all the adhesive is removed.

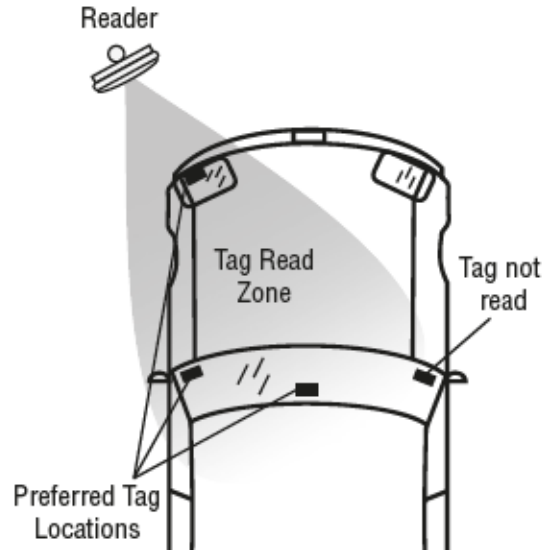

## Windshield Tag Installation Guide

### Dual-Purpose RFID Tag Mounting – Windshield:

The diagram below showing suitable mounting locations of windshield RFID tags. Choose a tag mounting location that meets your local vehicle code and is at least 2.5" (6.4 cm) from any materials containing metal. This includes the vehicle roof line, side pillars and review mirror mounting block. Make sure that the tag is not behind any metallic surface or darkened trim around the window.

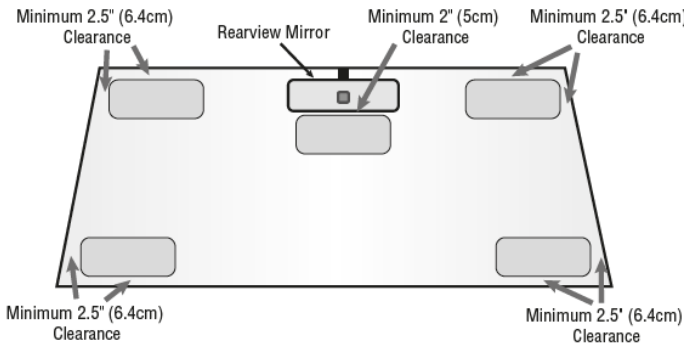

Interior Windshield Mounting Locations and Clearances

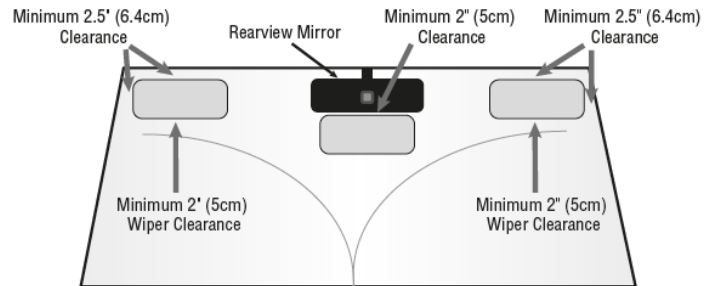

Optional Exterior Windshield Tag Mounting Locations and Clearances

### Dual-Purpose Vehicle RFID Tag Windshield Handling & Installation:

**NOTE:** Care should be given when mounting tags to windows or headlamp lenses containing conductive coatings or embedded radio antennas. These are often found on high-end vehicles. These can reduce the range or block RFID from working altogether.

**Step 1** – Make sure that the intended mounting surface is clean and free of any contaminants.



**Step 2** – Transfer the tag to the location on the vehicle that you have determined suitable for your application.

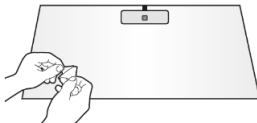

**NOTE:** Handle the tag with care during installation. Do not excessively bend or distort the tag when removing it from the liner.

**Step 3** – Smooth out the tag to ensure complete adhesion and remove any air pockets. It is best to apply the tag by the edges as showing the picture to the right.

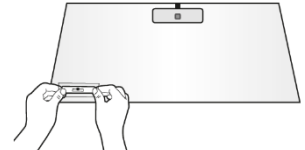

**NOTE:** Once the tag has been mounted, do not attempt to remove the tag. This will damage the tag and tag will become inoperable.

## Headlamp Tag Installation Guide

### Dual-Purpose RFID Tag Mounting – Headlamp:

For optimum performance, the RFID tag must be installed on the headlight lens or other suitable mounting location that is facing the RFID reader during normal driving.

### Alternative Mounting:

If mounting to the vehicle's headlamp is not feasible, you may also choose to mount the tag on other plastic surfaces, such as the vehicle's bumper, valance or side mirror. Many of the preceding guidelines will still apply and the tag must still be mounted a minimum of 2" (5 cm) from any metal structures. This includes any metal structures behind the bumper, such as metal grilles, bumper mounts or the vehicle's frame.

Choose a mounting location for the tag at least 2" (5 cm) from any material containing metal and approximately 2.5" (6.4 cm) from the bottom reflector.

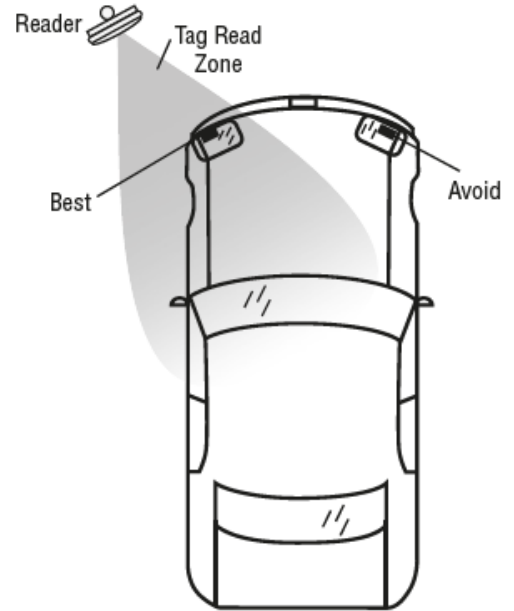

**Driver Side Reader Placement**

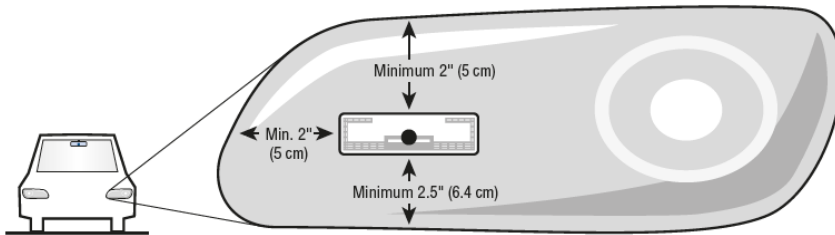

**Car Headlamp (front view)**

Clearance Shown for Distance between Hood, Body Panel and Bumper

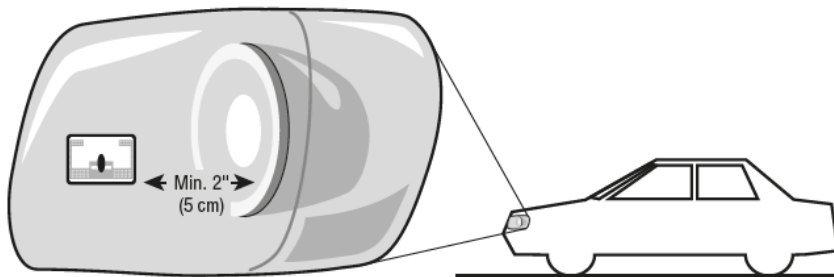

**Car Headlamp (side view)**

Clearance Shown for Distance between Headlamp Reflector Housing

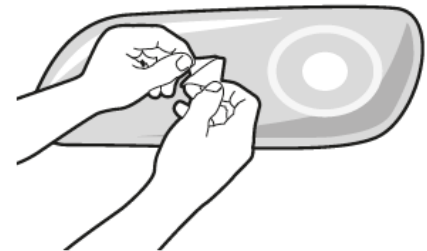

### Dual-Purpose Vehicle RFID Tag Headlamp Handling & Installation:

**NOTE:** Care should be given when mounting tags to windows or headlamp lenses containing conductive coatings or embedded radio antennas. These are often found on high-end vehicles. These can reduce the range or block RFID from working altogether.

**Step 1** – Make sure that the intended mounting surface is clean and free of any contaminants.

**NOTE:** Handle the tag with care during installation. Do not excessively bend or distort the tag when removing it from the liner.

**Step 2** – Transfer the tag to the location on the vehicle that you have determined suitable for your application. It is best to apply the tag by the edges as shown in the picture.

**Step 3** – Smooth out the tag to ensure complete adhesion and remove any air pockets.

**NOTE:** Once the tag has been mounted, **do not attempt to remove the tag.** This will damage the tag and tag will become inoperable.